

# MG-Magnetic Option

American Wheatley magnetic option for air separation devices.

The MG option includes a minimum of three diametrically charged magnetic assemblies inserted into the lower section of the air separation device. These high-powered magnetic assemblies attract small ferrous particles and magnetite, preventing them from flowing into the pump and further into the system. The internal magnets can be easily removed, allowing the particles to be flushed from the system during periodic blowdown, without system disruption. The positioning of the MG option in the bottom head of the air separation device, whether it is tangential or in-line, is located in an area of low velocity further assisting separation. Simply add the suffix -MG (TAS-004-MG) to the standard part number.

The MG option is available on American Wheatley TAS, TASS, IAS, IASS, SRS, STAD, and HVAD air separation devices.

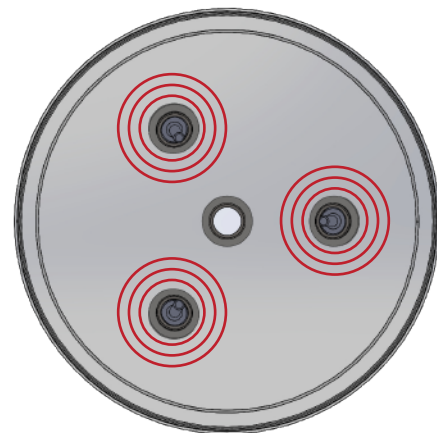
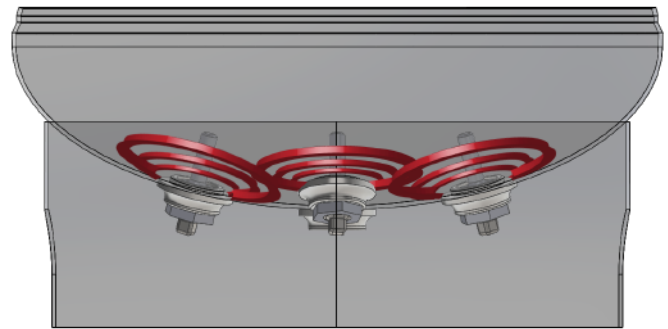

All packaging materials, thread protectors, plastic plugs and caps must be removed before installation.

Dimensions are subject to change without notice, please confirm actual dimensions with factory at time of order.

JOB NAME _____
LOCATION _____
_____
CONTRACTOR _____
CONTRACTOR P.O. NO. _____

ITEMS	QUANTITY
_____	_____
_____	_____
_____	_____
_____	_____
_____	_____

**American WHEATLEY**  
HVAC PRODUCTS®  
A GFP COMPANY

2701 W. Concord Street  
Broken Arrow, OK 74012  
Toll Free: 866-204-5229  
PH: 918-317-0401  
FAX: 918-317-0407  
www.wheatleyhvac.com  
e-mail: sales@globalflowproducts.com